

CLEANING AND SANITIZING INSTRUCTIONS

CAB CHILLED BEVERAGE DISPENSER

NOTE: The dispenser must be cleaned and sanitized at least once a week, or as required by local health regulatory agencies.

- 1** Drain product from the bowls and discard.

NOTE: Wait until the dispenser product level is low to clean and sanitize the dispenser.

2



Fill each bowl with warm water, let it sit for a few minutes to allow any remaining product to completely thaw, and drain the bowls again.

3

Remove the dispense valve by pulling out the white pin. Then remove the black handle, which will free up the valve body and spring.

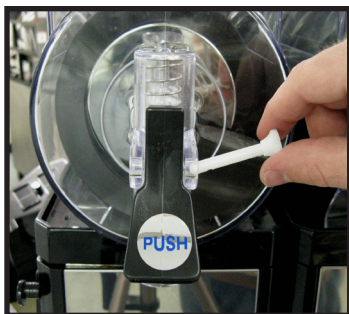

4

Remove the bowl by placing fingers under the front lower part of the bowl, near the dispense valve, and pushing upward until the bowl legs pop out.

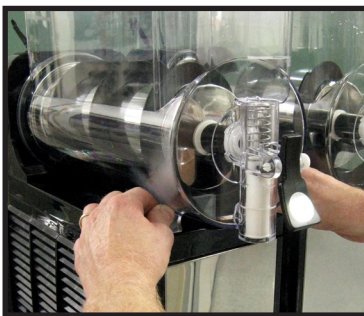

Then, placing fingers behind the bowl legs, pull slowly until the bowl is removed.

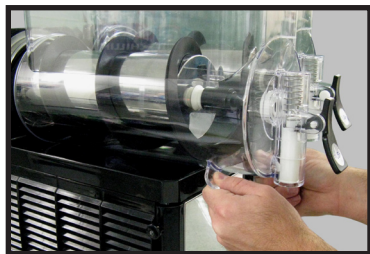

5

Remove the spiral blade and the suction cap gasket.

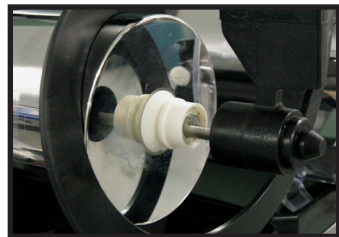

Suction cup gasket.

6

Remove the bowl gasket. Note that the inside of the gasket is tapered, as it will be necessary to install it later with the side of the gasket that has a larger diameter opening facing the rear of the machine.



7

Using warm water and a mild detergent, wash the bowls and all other parts removed from the dispenser.

Do NOT use abrasive cleaners or abrasive materials to clean dispenser parts or components.

8

Prior to reassembling, lubricate (using food grade lubricant) the suction cup gasket, the front of the evaporator (where the suction cup gasket contacts the evaporator), the head of the spiral blade, and the dispense valve body.

IMPORTANT: Do NOT lubricate the bowl gasket.

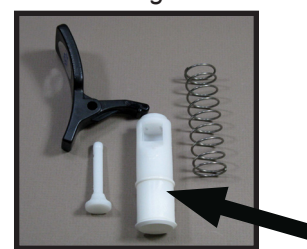
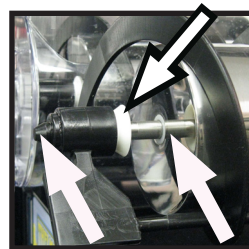

9

Reassemble and re-install all parts that were previously removed/disassembled and washed.

10

Using KAY-5 sanitizer or equivalent, prepare sanitizing solution with a minimum 100 ppm strength. Pour sanitizing solution into each bowl, up to the "MAX" line on the bowls, and run the machine for 2 to 3 minutes.

IMPORTANT:

Follow all safety procedures listed on sanitizer packaging.



11

Drain the sanitizing solution from the bowls completely and fill the bowls with fresh product.

NOTE: The dispenser must be filled only with freshly mixed product. Product removed from the bowls cannot be reused.

12

Draw and discard about a 1/2 cup of product from each bowl in order to clear any remaining sanitizer from the bowl or dispense valve.

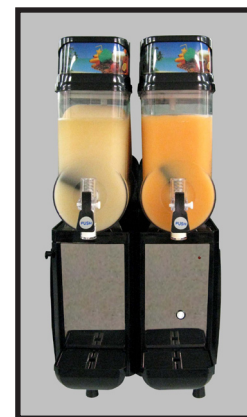

ATTENTION: Mixed product must be kept refrigerated at all times. If the dispenser is off or power is lost for more than one hour, the product must be drained and discarded, and complete cleaning and sanitizing of the dispenser must be performed.

ICEE PN 859997

The ICEE Company

Ontario, CA 91761
1-800-423-3872
4/22/2011